

EPICENTER 1000 SERIES
PLASTIC LAMINATE ATHLETIC LOCKERS



P.O. BOX 4090 • ONTARIO, CA 91761 • (951) 727-8600 • (951) 727-8612 FAX • WWW.IDEALOCKERS.COM

EPICENTER 1000 SERIES

PLASTIC LAMINATE ATHLETIC LOCKERS



Affordable and luxurious, our **Epicerter 1000 Series Plastic Laminate Athletic Lockers** are hand-made, and finely crafted using an endless choices of distinctively elegant laminates, with vinyl T-molding edging to mix, or match from five different color selections. Open space at the top of each locker provides storage for helmets and shoulder pads, all being set off by a bold trim piece. A security vault equipped with a dial combination lock, and mounted with a life time guaranteed, heavy duty euro-concealed hinges. Adjacent to the vault is a spacious hat shelf. Again, set off with a generous trim piece. Ample hanging space is provide in the midsection of each locker using a 1" diameter nickel plated coat rod, and two cast aluminum coat hooks. And, finally, the locker system provides an inside seat/lid with storage, and a hinged padlock hasp to keep items secure.

The frames are constructed from 48lb. industrial grade particle board. Doors are plastic laminate, high pressure, class II-B fire retardant with rounded corners. Frames and doors are edged with ployethylene vinyl T-moding. Interior surfaces of sides and back panel are finished with plastic laminate of your choice. All of our locker models are available in custom sizes to meet your individual needs.

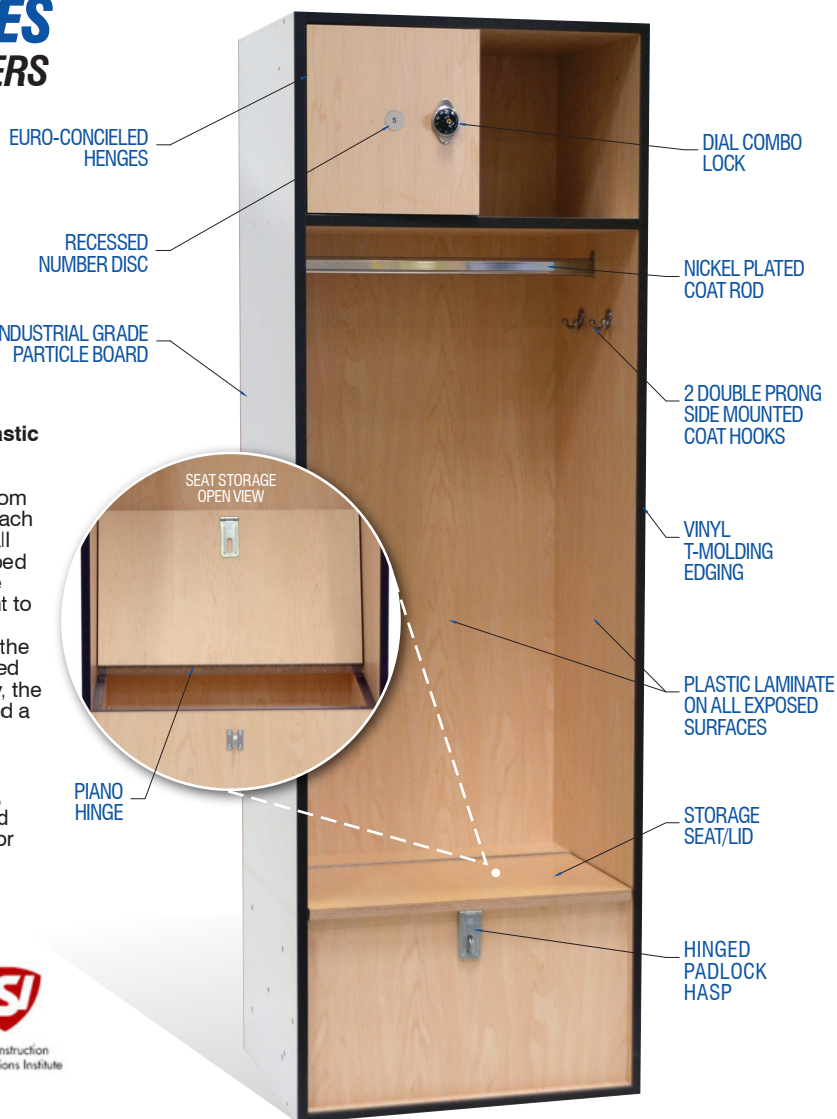
[LEARN MORE](#)

FEATURES

- Custom and standard designs
- Class II-B fire retardant, water resistant, .028" thick laminate
- Unlimited color and texture selection
- Formica®, Wilsonart®, Nevamar®, Pionite®, and Laminart®
- Large hanging/sitting area with coat rod & hooks
- Nickel plated coat rod
- Security vault with Dial Combination lock
- Side open cubby for helmet or hat storage
- 2 double prong side mounted coat hook
- Vinyl T-molding edging with color choices of black, white, grey, tan, or brown
- Heavy duty euro-concealed hinges on security vault and storage door
- Front opening, lockable bottom storage seat, with vent grill
- Three year warranty

INSTALLATIONS

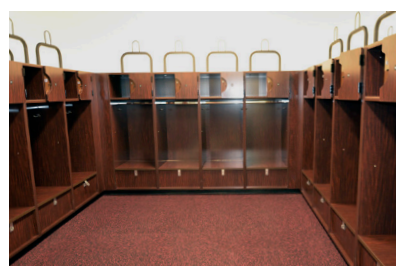
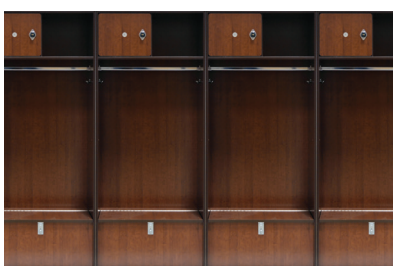

UNLIMITED COLORS & TEXTURES

With seemingly endless combinations of vibrant, versatile solid colors, inspirational patterns and textures such as woodgrains, including designs inspired by today's popular granite, marble and quartz looks, that are richly dimensional, realistically textured and intrinsically practical.

Plastic Laminate, class II-B, fire-retardant, water resistant, NEMA LD 3.1 vertical grade .028" thick high-pressure plastic laminate exposed. Available from **Formica®**, **Wilsonart®**, **Nevamar®**, **Pionite®**, and **Laminart®**



LOCKER DIMENSIONS

16"W x 18"D x 72"H - PL, VT, CH, DC

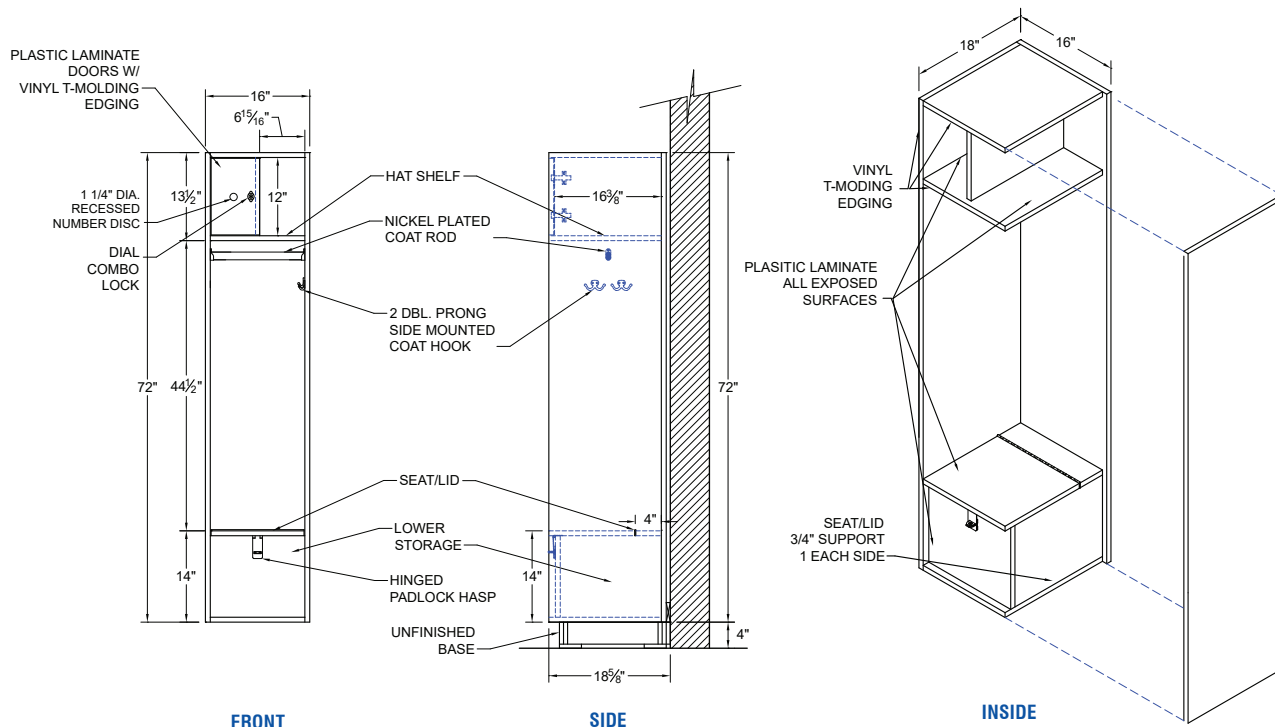

PRODUCT SPECIFICATIONS

- Frame Components**
 - 1000 Series include 3/4" fire retardant, high pressure plastic laminate on all exposed surfaces.
- Frame Construction** = Blunt joint, 2" t-head nail and screw.
- Edging** (select one)
 - 1000 Series includes 13/16" convex face, center barb, polyethylene Vinyl T-molding (VT) with color choices of black, white, grey, tan, or brown.
- Hinges** (select one)
 - 1000 Series includes heavy duty, euro-concealed, four way adjustable, 120 degree opening, self-closing, nickel plated hinges (CH).
- Doors** = 3/4" thick vertical grade .028" class II-B fire retardant plastic laminated two sides and 48 lb. industrial grade 1M2 particle board core.

ORDERING INSTRUCTIONS

Example:

Epicenter 1000 Series, Model X, 16 x 18 x 72", PL, DC, CH, VT

- | | | | | | | |
|---|---|---|---|---|---|---|
| 1 | 2 | 3 | 4 | 5 | 6 | 7 |
| 1 | 2 | 3 | 4 | 5 | 6 | 7 |
- Specify Epicenter 1000 Series for Plastic Laminate Athletic Lockers. Includes (VT) Vinyl T-molding, and (CH) Euro Concealed Hinges.
 - Select the style and size locker compartments such as Model X (standard), or customized it to your specifications.
 - Confirm the frame dimensions: Width x Depth x Height.
 - Select plastic laminate as your exterior surface and choose any color, or combination of colors.
 - Specify Locks. (RP) = Recessed Padlock Hasp, (PC) = Pushbutton Combination, (DC) = Dial Combination, (CL) = Card Lock, (CO) = Coin-Operated, (KL) = Keyed, (OCS) = Ojmar Digital [Optional Locks Available].
 - Specify Hinges. (CH) = Concealed Hinge.
 - Specify Edging. (VT) = Polyethylene Vinyl T-molding.

AIA SPECIFICATIONS

EPICENTER 1000 SERIES

PLASTIC LAMINATE ATHLETIC LOCKERS

Requirements of Divisions 0 and 1 apply to work of this section.

1.0 GENERAL

1.1 SCOPE OF WORK INCLUDED

- A. The furnishing and installation of prefabricated WIC Type I multiple self-supporting modular water resistant, custom grade, natural wood lockers.

1.2 RELATED WORK SPECIFIED ELSEWHERE

- A. Architectural Woodwork - Section 06400
- B. Wood and Plastic Doors - Section 08200
- C. Wood and Plastic Windows - Section 08210

1.3 STANDARDS

- A. Minimum standard for water resistant, natural wood lockers shall conform to WIC "Manual of Millwork" latest edition.

1.4 QUALITY ASSURANCE

- A. All parts and hardware shall be WIC compliant, structurally sound and free from defects, in material and workmanship under normal use and service for a period of three (3) years. All lock parts warranted for a period of one (1) year by the respective manufacturer.

1.5 SUBMITTALS

- A. Submit two copies of AWS compliant shop drawings for all items of finish work before fabrication.
- B. Manufacturer's descriptive data of all materials and products construction, overall dimensions for installation of lockers, accessories, and trim.
- C. Submit four (4) 4x4" stained finish on plain slice white birch veneer for architects approval.

1.6 PRODUCT HANDLING, DELIVERY & STORAGE

- A. Deliver all lockers when project construction is ready for installation. Store lockers in dry, ventilated area and protect all finishes from soiling and damage during handling.

2.0 PRODUCTS

2.1 GRADES

- A. Furnish EPICENTER 1000 Series furniture grade plastic laminate lockers in accordance with WIC "Manual of Millwork", Section 15 - Plastic Covered Casework for Custom and Premium Grades.

2.2 ACCEPTABLE MANUFACTURER

- A. Ideal Products, Inc. PO Box 4090, Ontario, CA 91761.

2.3 MATERIALS

- A. Locker Interior:
3/4" fire retardant, high pressure plastic laminate on all exposed surfaces.
- B. Doors, End Panels, Sloped Tops
 - 1. Plastic laminate, high pressure, class II-B fire retardant, VGS-GP28, 1/4" STD PB, UL & HPMA.
 - 2. Radius corners for 1000 Series edges finished with 13/16" convex face polyethylene Vinyl T-molding (VT).
 - 3. 3/4" thickness 48 lb. industrial grade particle board with choice of vertical grade fire retardant (class II-B) plastic laminate for exterior finish and interior Wilsonart 1573 vertical grade frosty white cabinet liner.

2.4 HARDWARE

- A. Hinges, heavy duty, Euro-concealed, 6 way adjustable, 125 degree opening, self-closing, nickel plated, lifetime guarantee (CH) on vault door.

- B. Clothes hooks, double prong stainless steel and 1 1/16" coat rod.

2.5 FABRICATION

- A. Lockers shall be fabricated using blunt joint, nail and screw joinery.
- B. Fabricate lockers square, rigid, and without warp.
- C. Machine all parts and attachment holes accurately and without chips.
- D. Fabricate corners, fillers, scribes, tops as required for installation.

3.0 EXECUTION

3.1 CONSTRUCTION

- A. Conform to requirements of WIC "Manual of Millworks", latest edition, for joinery requirements using blunt joint, nail and screw construction.

3.2 INSTALLATION

- A. Install lockers at the locations shown in accordance with manufacturer's instructions for plumb, level, rigid and flush installation.
- B. Lockers are easily installed on a standard prefabricated 4 x 17 x 72" unfinished bases per locker room layout, cut to fit as required, level bases using readily available shim shingles.
- C. Hang wall straps locker height less 1/2" above bases, spaced approximately 4 to 5 feet apart.
- D. Stack lockers one next to the other per plans, allowing approximately 24" separation in corners, bolt each from together using manufacturer supplied fasteners through predrilled holes. Be sure to align leading edges of locker frames with each other as fasteners are tightened.
- E. Install end and corner fillers and caps, cut to size in field per plans.
- F. Install end panels.
- G. Install number discs, clean lockers, remove all related trash and debris from job-site.

3.2 CLEAN-UP

- A. Upon completion of the work, remove surplus materials, rubbish and debris resulting from the operations under the section, including equipment and implements of service, and leave the entire structure and site insofar as the work of this section concerned in a neat, clean, and acceptable condition.

3.3 WARRANTY

- A. Ideal Products, Inc. warrants its Natural Wood Lockers, properly maintained, against delamination, breakage or corrosion for 10 years from the date of receipt by the customer. If materials are found defective during that period for the reasons listed above, the material will be replaced free of charge.
No credits or allowances will be issued for any labor or expenses related to the replacement of components covered under the warranty plan. All such expenses are to be borne by the buyer.

Ideal Products, Inc. reserves the right to change/modify specifications at any time.

LOCKER ROOM DIAGRAMS

General Notes

- Locker to be standard as manufactured by Ideal Lockers.
- $\frac{5}{8}$ " spacers edged with matching edging to allow for hand clearance.
- Single end panels $18\frac{5}{8}$ " wide to cover rear ventilation.
- Double end panels $36\frac{5}{8}$ " wide to allow for air space.
- Fillers are required.
- TLW (total locker width) = Total number of lockers x locker width. 12" lockers are 12.0625" wide; 16" lockers are 16.0625" wide.
- Consult factory for requirements.

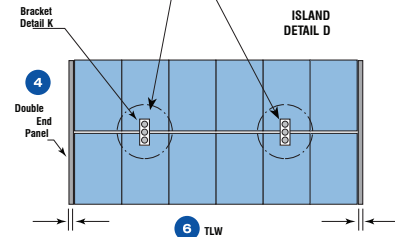
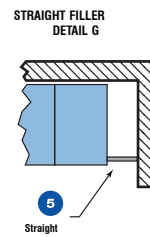
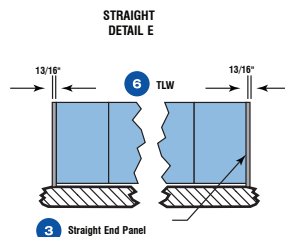
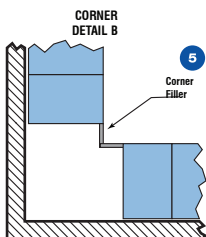
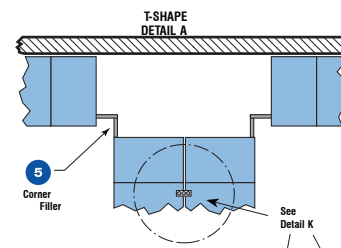
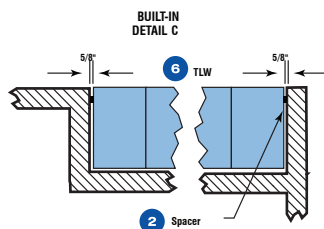
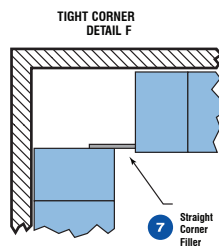
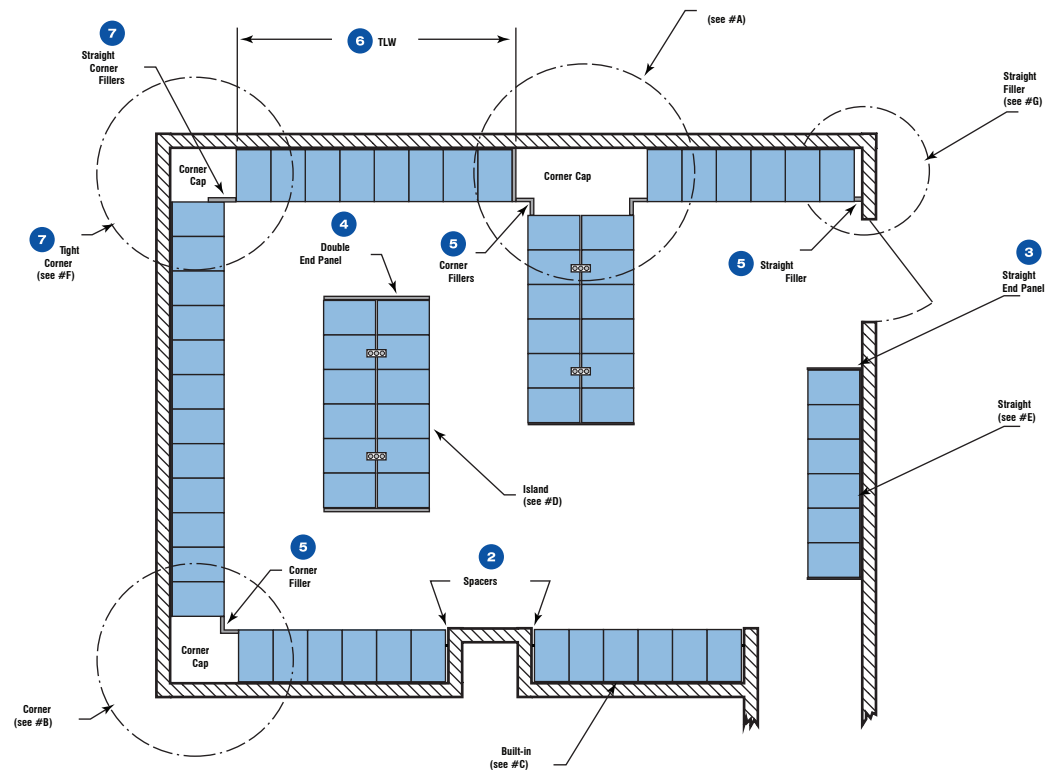

HANDICAPPED OPTIONS

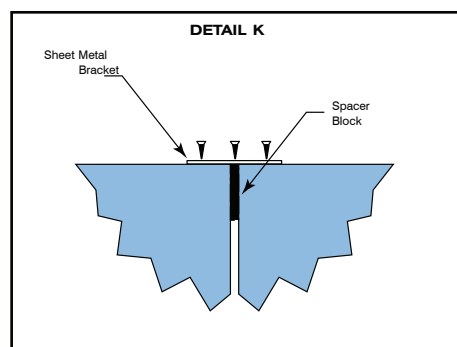
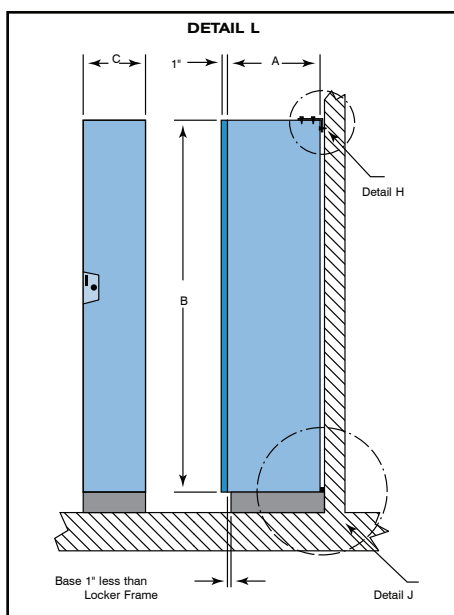
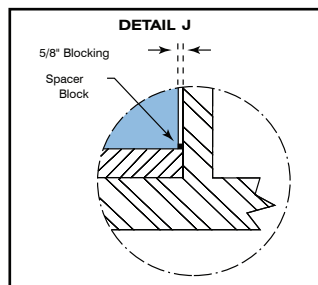
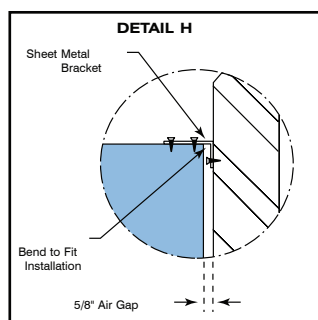
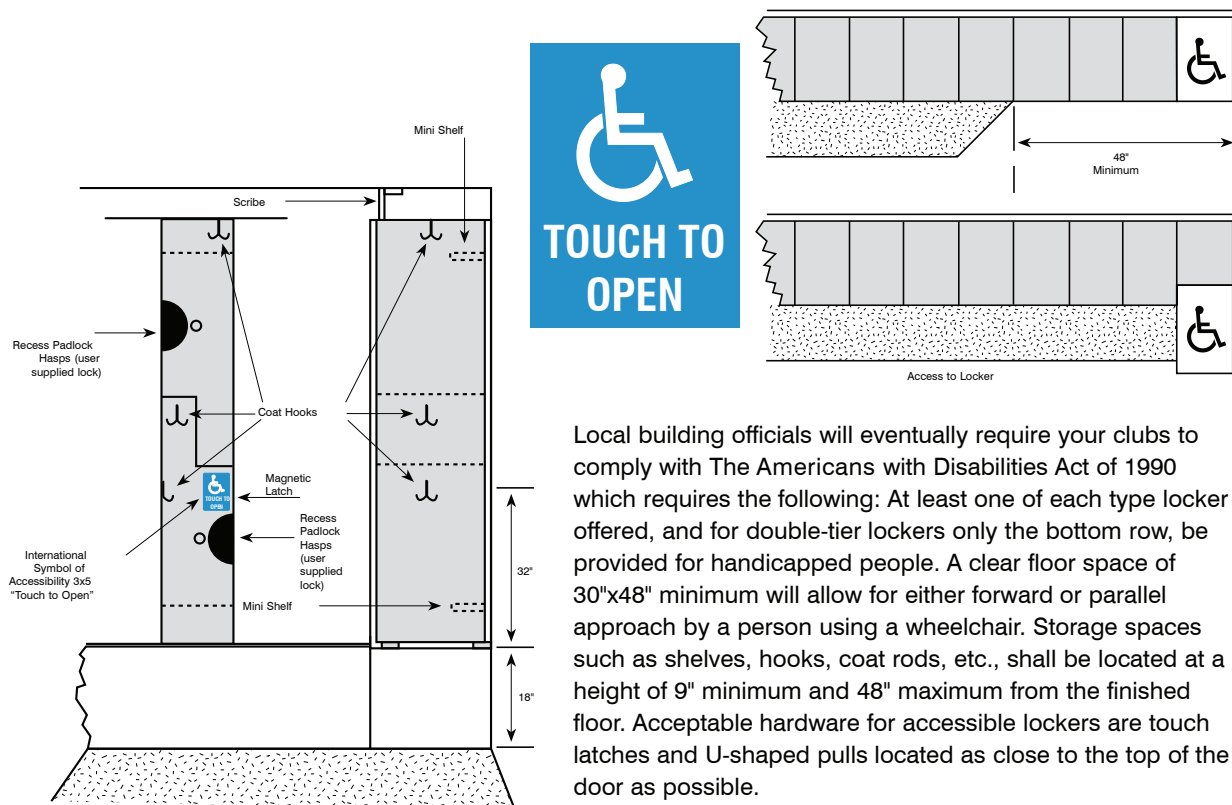



IDEAL PRODUCTS, INC. • P.O. BOX 4090 • ONTARIO, CA 91761 • (951) 727-8600 • (951) 727-8612 FAX • WWW.IDEALOCKERS.COM