

CAM LOCK

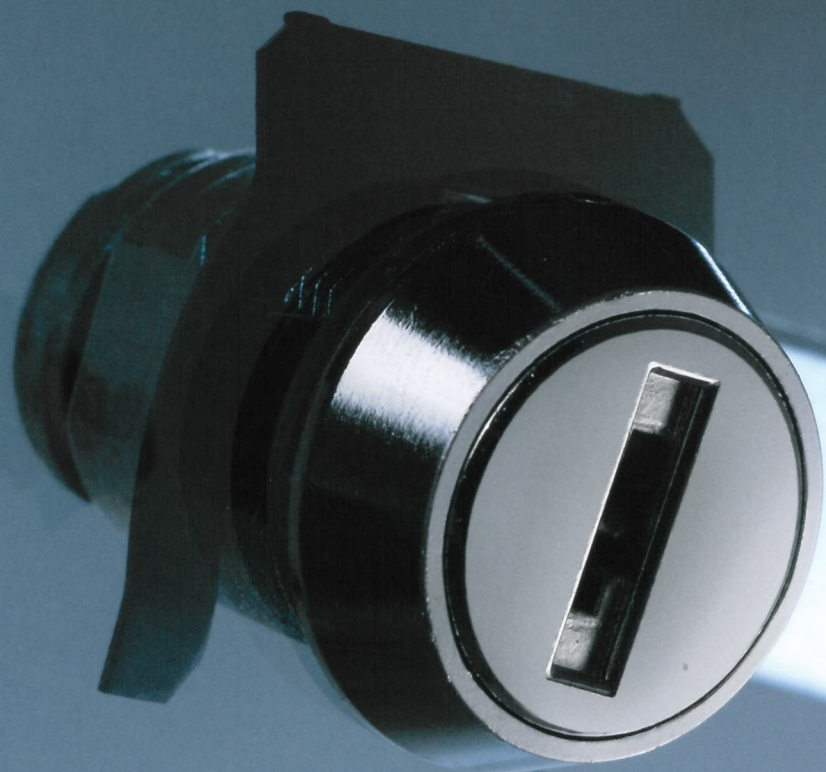

ojmar

10-WAFER CYLINDER CAM LOCKS FOR DRY AREAS



REF. 603 

A range of cam locks for dry-area facilities: gyms, shopping centres, schools, etc. Designed specifically for thin [e.g. metal] locker doors.

REF. 617 

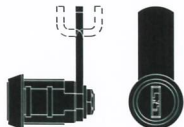
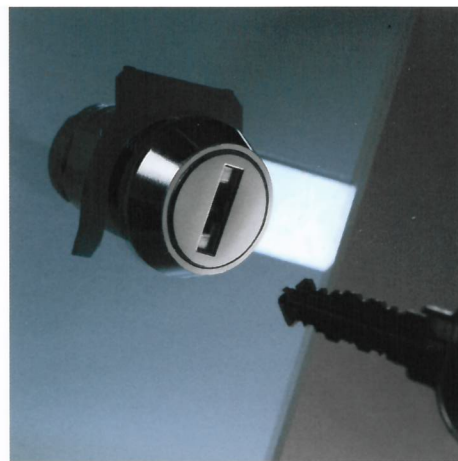
A range of locks designed for lockers with thicknesses of up to 20mm.

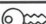

MODEL	Ref. 603 	Ref. 617 
MAIN FEATURES		
FIXING HOLES	Clip or nut	Nut
ROTATION	90°	90°
CYLINDER	10 wafers	10 wafers
KEY	Reversible with round head	Reversible with round head
DIFFERS	Up to 2500	Up to 2500
FINISH	● Chrome	● Chrome
MATERIALS		
INTERNAL PARTS	Die cast	Die cast
CYLINDER	Die cast	Die cast
KEY	Nickel plated brass	Nickel plated brass
DIMENSIONS		
Ø HEAD	Ø 23 mm	Ø 24,3 mm
HEAD THICKNESS	6,5 mm	4,5 mm
LENGTH (L)	22 mm	30 mm
CAM DIMENSIONS	15x3xR mm	15x3xR mm
MINIMUM DOOR THICKNESS	1 mm	1 mm
MAXIMUM DOOR THICKNESS	15 mm	20mm
DIMENSION OF FIXING HOLE	16,2x19,2 mm	16,2x20,2 mm
MECHANICAL REQUIREMENTS		
N° OF CYCLES	65,000 machine cycles according to LGA	65,000 machine cycles according to LGA
TORSION	DIN 68.852	DIN 68.852
KEY	300 N	300 N

ACCESSORIES

Bracelet

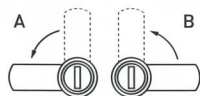

Key can only be removed in closed position.

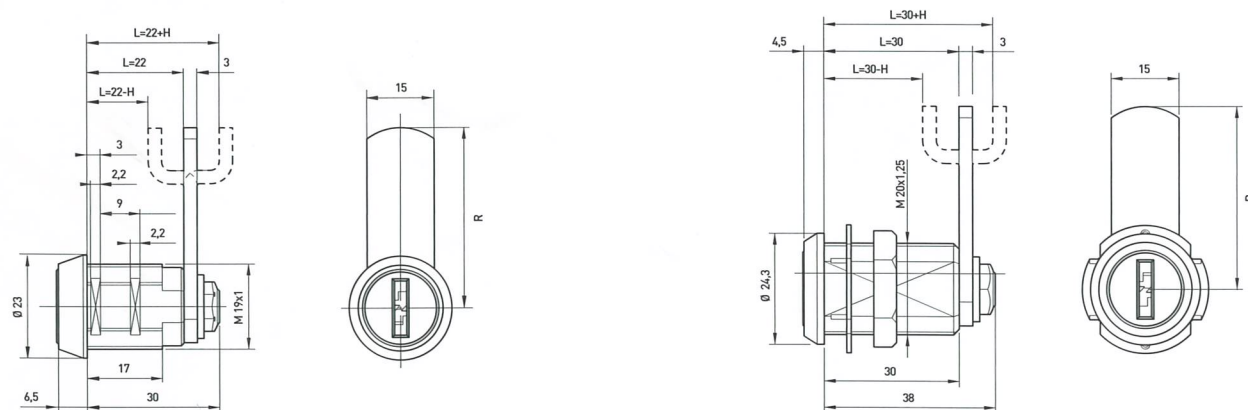

OJMAR, U.S.
1289 Heather Drive, Holland, MI 49423
toll free: 888-795-5588
iames@ojmar.com · www.ojmar.com



OJMAR, S.A.
Pol. Ind. de Lerun, s/n · 20870 Elgoibar · ESPAGNE
Tel: + 34 943 748 484 · Fax: + 34 943 748 490
www.ojmar.com