

# MATERIAL & INSTALLATION GUIDE

---



Ideal Products, Inc.  
P.O. Box 4090  
Ontario, CA. 91761

Toll free: 1(800) 88-IDEAL  
Tel. (951) 727-8600  
Fax. (951) 727-8609

E-mail: [idealocker@aol.com](mailto:idealocker@aol.com)  
[WWW.IDEALOCKERS.COM](http://WWW.IDEALOCKERS.COM)

“At Ideal Products, Inc. you will find the highest standards in custom design and the best quality of wood and plastic laminate lockers”



Cert no. SCOCOC-402382

© 1996 Forest Stewardship Council



# Thank You

---

First of all we would like to thank you in making Ideal Products, Inc. your choice in wood and/or plastic laminate lockers. It is an honor to have you as a customer and we look forward to working with you on this project to ensure the most professional locker installation .



# Purpose

---

This pamphlet is to be used as a guide to help you with the care and installation of your new lockers. Here you will find descriptions of the material you will or have received from us, as well as care tips and standard installation instructions. Please, we recommend that you read through this pamphlet and if you have any additional question you can always contact us. We are here to assist you. *(See contact information on the cover page of this pamphlet.)*

We are available: **Monday - Friday; 7am - 4pm Pacific time.**



# Care and Handling

---

Prior to loading and shipping your lockers, our quality control team conducts a thorough inspection of every single unit to ensure that you are getting a high quality and clean product. We also make sure that the lockers are packaged correctly and loaded properly and securely.

We insist and urge you in handling your new lockers with care, from the time you unload to the final installation. Remember that the lockers are part of the furnishing and décor of your facility. Proper care and handling will result in a professional and attractive locker room.

## **Unloading**

You will need to have a crew available to unload the trailer. Advise your crew on the care and handling of your shipment. Please note that it is not the responsibility of the driver to assist with the unloading or handling of your order in any way. Depending on the size of your shipment, additional people may be required to assist in unloading. Keep in mind that the bed of the truck is above ground level.

If your order is delivered in crates or pallets, be advised that they are very large and heavy. Special equipment such as a forklift or a pallet jack may be useful. For loose deliveries, hand trucks or dollies would be sufficient (for moving lockers with hand trucks or dollies see procedures below).

## **Moving Lockers w/ Hand Trucks or Dollies**

It is advised that you use a dolly or hand truck to move the locker units around. When doing so follow these three simple steps:

1. Mount the locker on the hand truck through one of the unfinished sides (typically the back or sides)
2. When moving keep one hand on the locker for stability.
3. Ensure that there is sufficient space on the path where the locker is to be moving through to avoid accidental damages to the unit.

## **During Installation**

Make sure that you use proper lifting procedures when lifting the lockers. Be aware that some lockers are heavy and may require more than one person to lift. Avoid dropping the lockers. Also make sure that you are free of any sharp objects that might be on you such as keys, tools, belt buckles, etc. These may potentially scratch and damage the locker when lifting or handling them. Finally, do not lay lockers on the doors or any finished side.

---

---

**When it comes to care and handling of any type of furniture, the key is to practice common sense.**



# Standard Installation Hardware

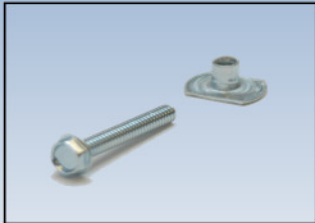

**5/16" Hex Bolt & T-Nut**  
*These are used to attach the lockers together*



**Connection Screws (Male & Female)**  
*These are used to attach Cubbies or Epicenters Together.*



**Long Screw (1-5/8")**  
*Are used to attach Fillers, Corner Fillers, Scribe & Fascia.*

**Short Screw (1-1/4")**  
*Are used to attach Single End Panels, Double End Panels, Finished Top & Bottom Panels, And Sloped Tops.*



**Metal Wall Strap**  
*1x6" aluminum plate w/ 3 holes used to attach the lockers to the wall or back to back lockers.*



**Number Disc**  
*These are stacked and wrapped with masking tape. Up to 20 ea. roll.*

## **ATTENTION**

Most of the hardware is contained in small plastic bags and packaged in a small 6x6-1/2 x6-1/2" cardboard box that is marked as such. The box (or boxes) can be found inside one of the lockers that is also marked with the word "Hardware".



# Other Hardware

## ADA (Americans with Disabilities Act)

### Package



**ADA International Symbol Stickers**  
3x5" stickers that must be used to indicate ADA compliant lockers. "Touch To Open" label used on lockers that port an optional touch to open latch (see below)



**Double Prong Side Mounted Coat Hook**  
On an ADA locker it is recommended to install hook at a minimum height of 32" off the finished floor.



**Touch To Open Magnetic Latch (optional)**  
Magnetic spring latch w/ attaching screws and metal plate. Used for easy door opening action.  
*Note:* Latch can not be used on lockers with self closing concealed hinges.

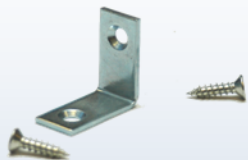

**Metal L-Brackets**  
With screws used on ADA lockers to attach adjustable shelf.



**4" Wire Pull**  
Used on ADA lockers for easy hand grip pulling.

### MISC.



**Wood Dowel**  
1-1/2" long, 3/8" diameter wood dowel used to attach bench tops together on the 3000 series lockers.

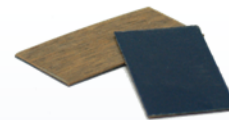

**Plastic Laminate Strips**  
1x2" small strips used to align sloped tops together by inserting them in the pre-slotted sides.

**NOTE:**  
If these are included in your order, the hardware above will also be packaged as the standard material shown on the previous page.

#### Other material to look for, if required or requested per job:

- ⇒ Fillers
- ⇒ End Panels
- ⇒ 5/8" Finished Spacers
- ⇒ 5/8" Spacer Blocks
- ⇒ Corner Caps
- ⇒ Sloped Tops
- ⇒ Finished Top or Bottom Panels
- ⇒ Unfinished or Finished Base (standard 4")

#### For 3000 Series Lockers also look for:

- ⇒ 1 1/2" Unfinished Base
- ⇒ 1 1/4" Bench Top
- ⇒ Lower End Panels
- ⇒ Lower Fillers
- ⇒ Lower 5/8" Finished Spacers
- ⇒ Corner Supports w/ base blocks



# Standard Locker To Wall Installation Detail

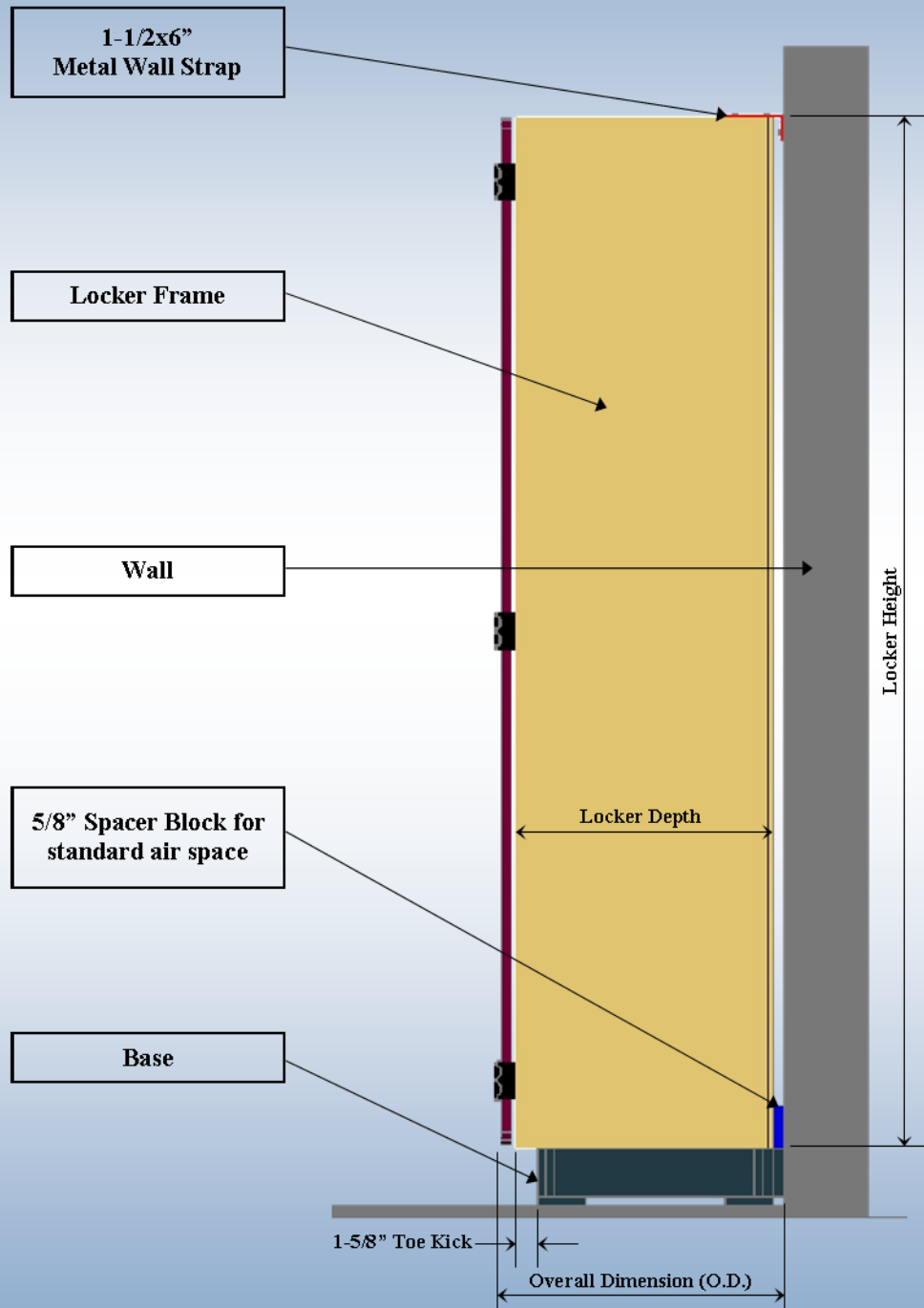

# Quick Installation Instructions

---

**Plan your locker layouts prior to installation.**

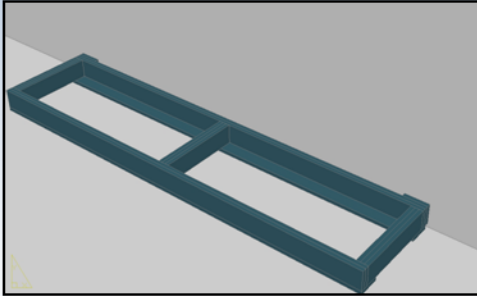

## STEP - 1

Set the base and ensure that it is leveled.

Standard bases supplied by Ideal are 4" high by 72" long by the width that equals 1" less than the locker depth. (2x4 type construction)

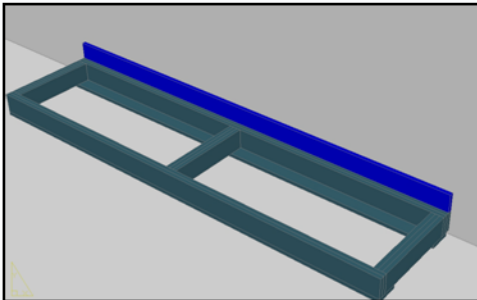

## STEP - 2

Set the 5/8" spacer block on the base and against the wall for standard air space.

Supplied at 3x72"

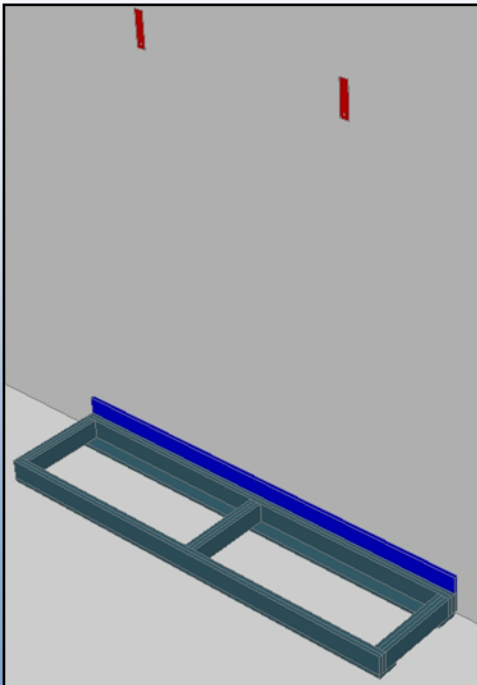

## STEP - 3

Attach the *metal straps* to the wall through the lower hole at approximately 1" below the height of the locker and 48" or 4 frames apart.

**Note:** Assure that the straps are attached where studs are located behind wall for a stronger hold.

# Quick Installation Instructions (continues)

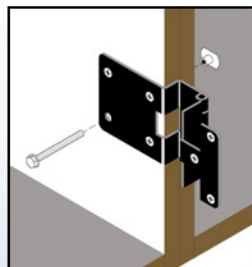
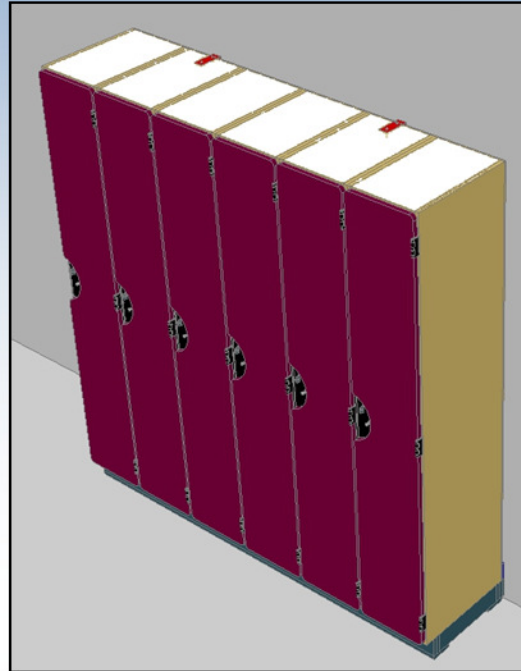
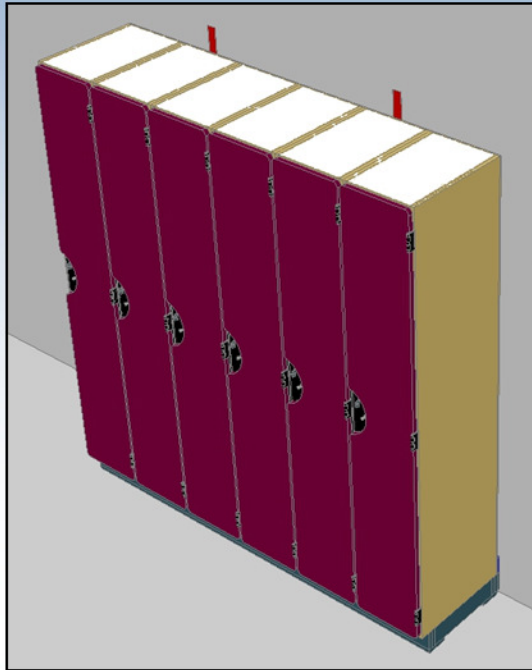

## **STEP - 4**

Place the lockers on the base side by side and level them. Using a locking C-clamp to hold them in place, bolt them together through the predilled holes (In most cases these are located on the hinges). Use a *5/16" hex bolt and T-nut* for lockers or Connection male & female screws for Epicenters and Cubbies.

## **STEP - 5**

Fold and screw the metal straps to the top of the lockers using the *Hex head screws* provided.

## **STEP - 6**

Proceed with the installation of all other material that may apply to your project. See following pages for details on each installation.



# Filler and Finished Spacer Installation Instructions

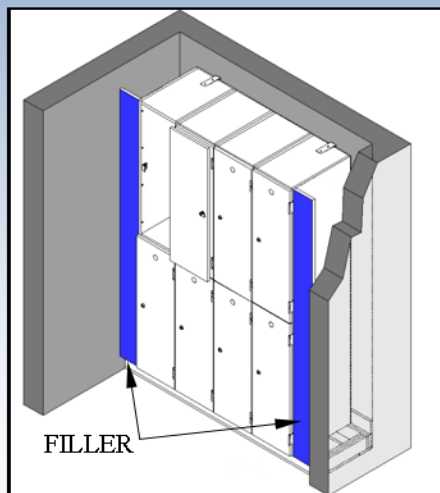

## Fillers

Fillers are 3/4" material with 1 finished side, provided at 12" wide with height equal to locker and may be cut to fit in the field.

To install, cut the fillers to the required width. Align the face of the filler with the edge of the locker frame and using *1-5/8" Long wood screws* attach them through the inside of the lockers.

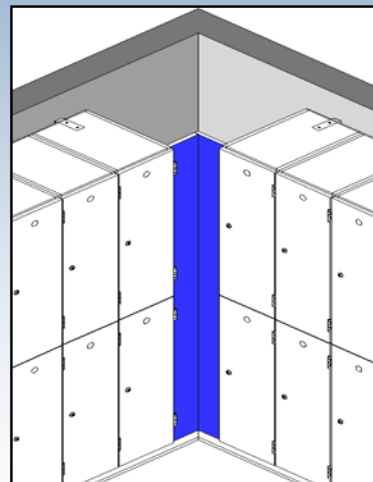
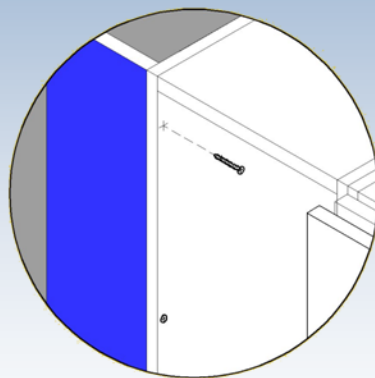

## Corner Fillers

Fillers are 3/4" material with 1 finished side, provided at 12" wide with height equal to locker and may be cut to fit in the field.

To install, cut the fillers to the required width and assemble an L shape corner filler prior to attaching it to the lockers. Once L shape is assembled align the face of the filler with the edge of the locker frame, using *1-5/8" Long wood screws* attach them through the inside of the lockers.

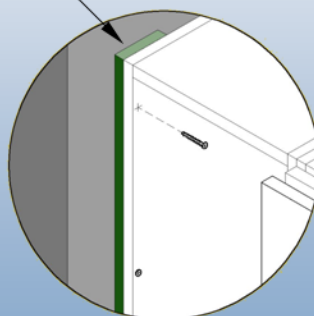
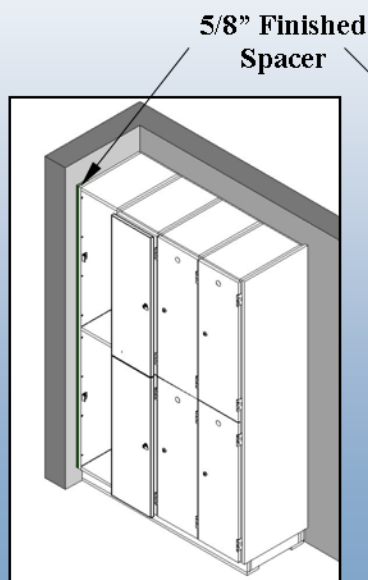

## Finished Spacer

Spacers are 5/8" material 3" wide and Height equal to locker with a finished edge to match edging on lockers.

To install, set the filler between the wall and the locker. Using *1-5/8" Long wood screws* attach it from the inside of the locker.

# End Panel & Corner Cap Installation Instructions

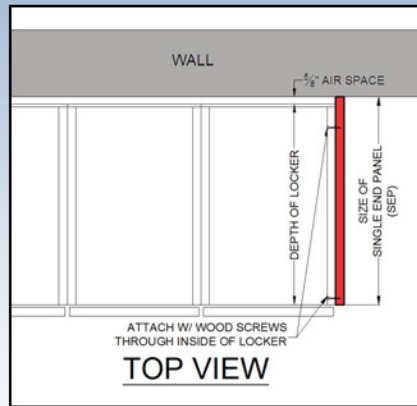
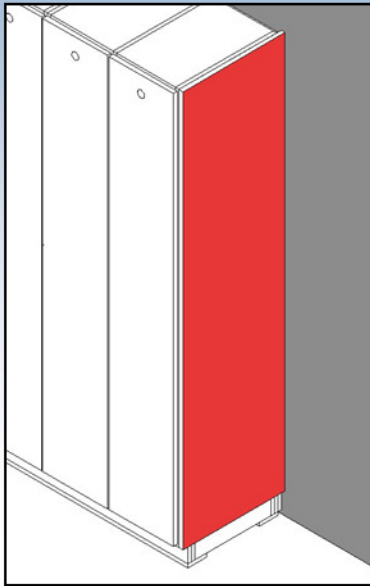

## End Panel

End Panels are 3/4" material with one finished side and finished edging all around.

**Single End Panel:** size is the depth of the locker plus 5/8" by the height of the locker.

**Double End Panel:** size is the depth of 2 back to back lockers plus 5/8" by height of the locker.

To install, set the end panel and align the edge of it to the edge of the locker frame and using a

locking C-clamp to hold in place, Attach them to the locker by using 1-1/4" short wood screws.

### Note:

On a 3000-3 series lockers w/ a lower platform, lower end panel can be attached using a strong wood adhesive.

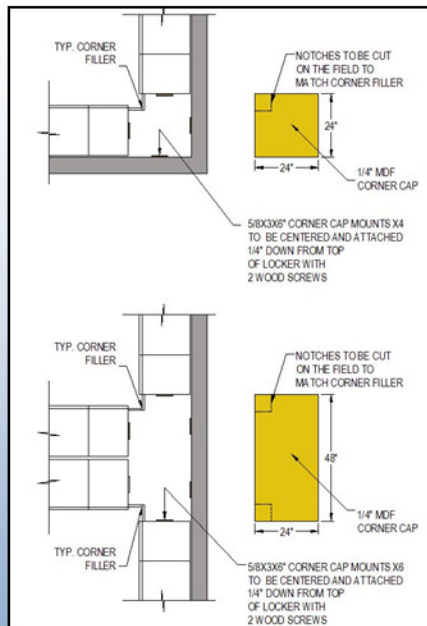
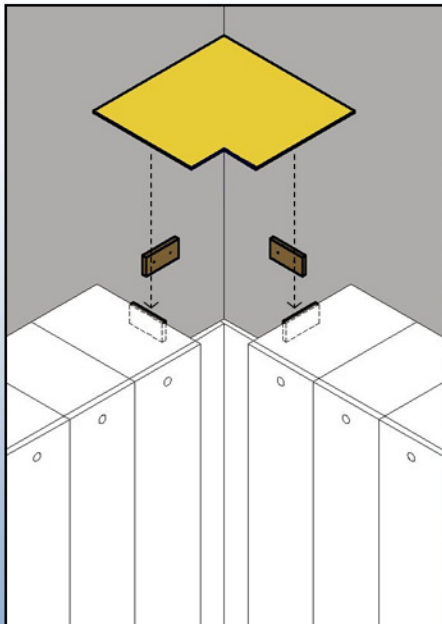

## Corner Caps

Corner caps are supplied equal to the maximum corner size of your project. They are 1/4" thick MDF unfinished material

To install, place corner cap mounts on the inside of the corner. Locate them 1/4" below the top of the locker and attach them with wood screws. Then cut the corner caps to the size of the corner. Cut the notch to fit the corner filler and place the cap on top of the mounts. Secure the cap with wood screws if necessary.

# Wall Mounted Locker Installation

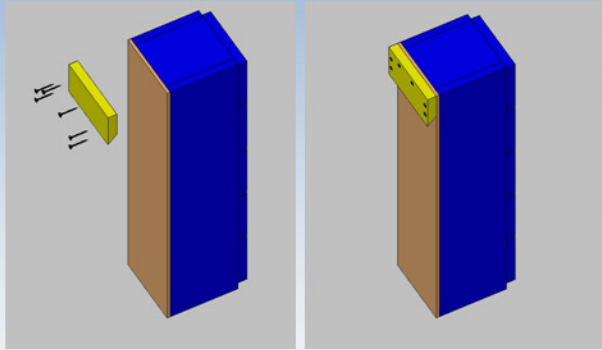

- 1 Cut and attach bracket to the back of the lockers

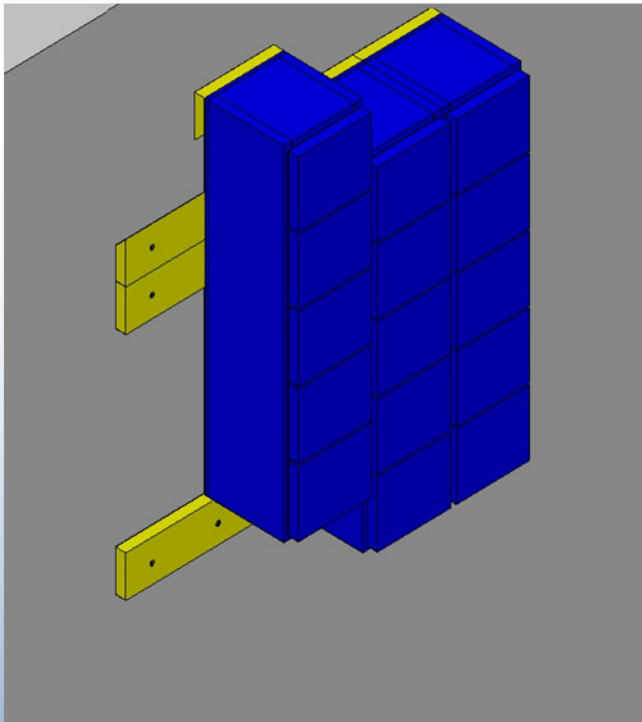

- 3 Carefully mount locker to the bracket on the wall and bolt them together (see Step 4 on page 8)

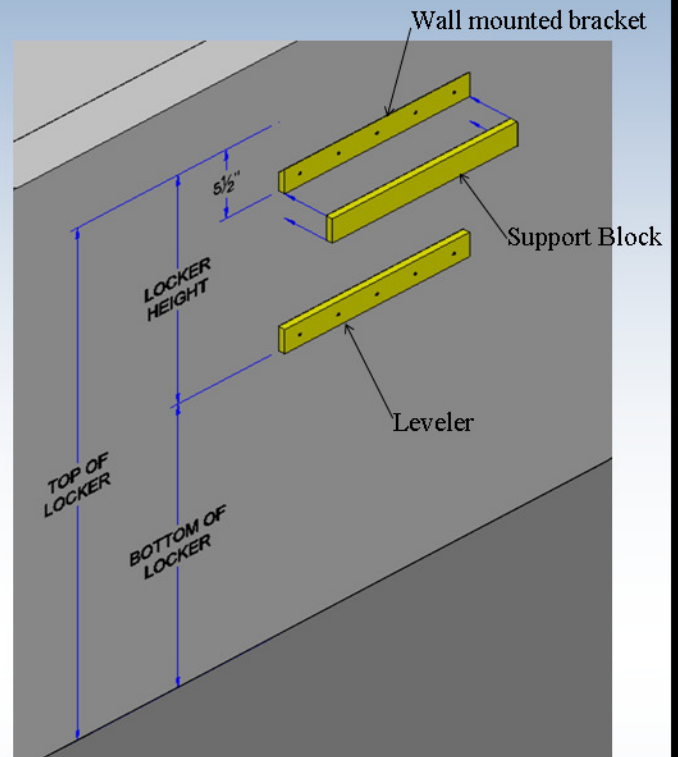

- 2 Level and attach the wall mounted bracket. Next attach support block below bracket and last level and attach the leveler to the wall. Assure that they are screwed through the wall and into the studs for a stronger hold.

## Other Installation Detail

---

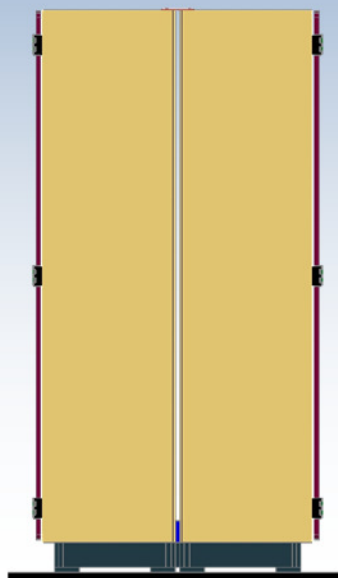

### Back to Back Lockers

On this type of installation, lockers are placed back to back on top of the base. If the supplied base is being used, remove the 5/8" rear blocking from one of the bases and place them back to back. Removing the blocking allows for a consistent 1-5/8" toe kick. Place a 5/8" spacer block in between the lockers for a 5/8" standard air space. Finally, strap the lockers at the top on every 3rd frame using the metal straps provided.

**Note:** On back to back lockers with sloped tops, installation is the same with the exception that the airspace is double the size from 5/8" to 1-1/4" with two 5/8" spacer blocks between the lockers. This is done to accommodate the back to back sloped tops.

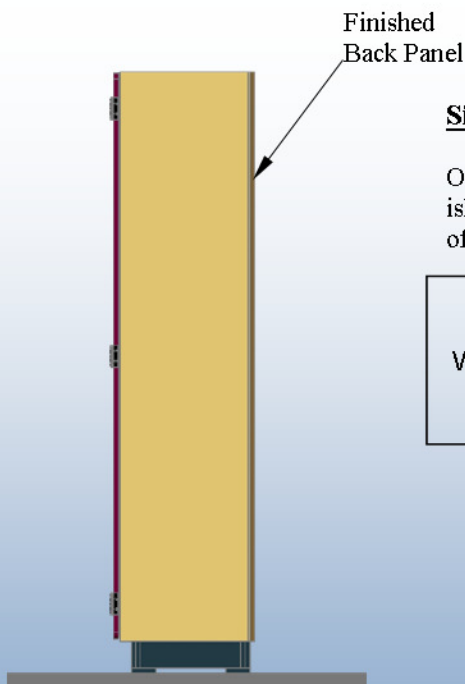

### Single with Finished Back Panel

On this type of installation, lockers are placed on top of the base and a Finished Back Panel is attached to the rear with wood screws through the inside of the lockers.

### **ATTENTION!!**

WE DO NOT RECOMMEND THIS TYPE OF INSTALLATION WITHOUT ANY ADDITIONAL VERTICAL SUPPORT.

# Other Top Installation Detail

---

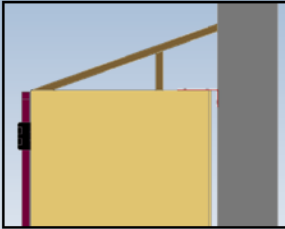

## With 20° Sloped Top

- Sloped tops are provided at 48" in length.
- Some sloped tops must be cut to fit in the field.
- Sloped top corner sets are pre-fabricated to fit a 90° corner run.

On this installation the sloped tops are placed on top of the locker and against the wall. Sloped tops are then attached with 1-1/4" *short wood screws* through the inside of the lockers at about 2" from the front edge of the frame ( $\pm 1/8"$ ). When joining two sloped tops together, align them by inserting the 1x2" *plastic laminate strips* in the pre-slotted edges of the sloped tops.

---

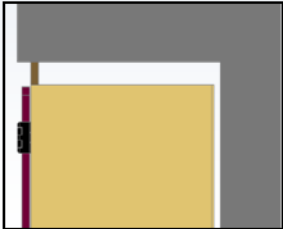

## With Scribe

- Scribes are provided at 48" in length.
- Some Scribes must be cut to fit in the field.
- We recommend that the scribe be at least 2" high.

Scribes are placed between the top of the lockers and the soffit or ceiling and aligned with the front edge of the frame. They are then attached with wood screws through the inside of the lockers. For some taller scribes an extra block support attached to the soffit or ceiling behind the scribe may be used for extra support.

---



## With Fascia

- Fascia is provided at 48" in length.
- Some Fascias must be cut to fit in the field.

Fascias are placed on top of the lockers with its front aligned with the front edge of the frame. They are then attached with wood screws through the inside of the lockers.

---

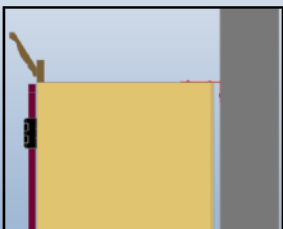

## With Crown Molding

- Crown Molding is provided at 96" in length.
- Some Crown Molding must be cut to fit in the field.

Molding is placed on top of the lockers with its edge aligned with the edge of the locker frame and attached through the inside of the lockers, using wood screws.



# Other Bottom Installation Detail

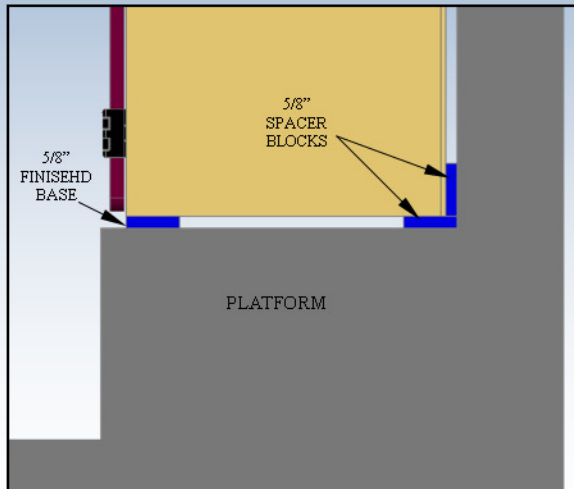

## On A Platform

On this installation you must sit the locker on top of a 5/8" spacer block at the back and a 5/8" finished base at the front. Make sure you place a 5/8" spacer block between the wall and the locker for air space.

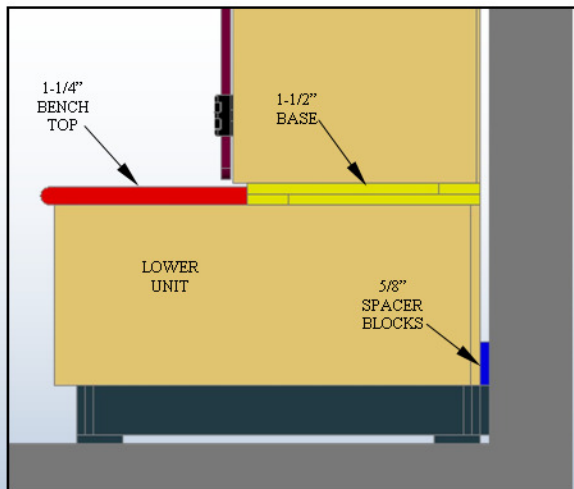

## 3000 Series

Material to look for:

- 4" Base (if requested)
- Lower Unit (typically Lower Cubbies, Finished Platform or Lower Locker)
- 1 1/2" Base (supplied in 72" length)
- 1 1/4" Bench Top - Supplied in 96" in length

For installation, make sure the base is set in place and leveled. Place the 5/8" spacer block for the air space between wall and lower unit as shown. Set the lower units on top of the base and bolt them together (similar to lockers). Next, place the 1 1/2" base on top of the lower units aligning both back ends. Attach the base with wood screws. After that, sit the lockers on top of the 1 1/2" base and bolt the lockers together as well and strap them to the wall if possible.

Finally set the bench tops at the front end of the lower unit making sure that it is flush against the 1 1/2" base. Attach the bench top through the inside of the lower unit with wood screws.

**Note:** if the lower unit is a finished platform, strong adhesive such as Liquid Nails can be use to attach bench in lieu of wood screws.

# ADA Package Installation Detail

